

405 HTS

Derived from a lineage of spirited Galeon cruisers, the 405 embodies its sporty heritage with a hull tuned for speed and dynamic handling. Its open design centers on the main deck, inviting passengers to relish the invigorating experience offered by the HTS model.

While sporting Galeon's signature edgy features and expansive windows, the 405 stands out with a retractable soft-top roof over the cockpit, providing respite from the sun's intensity. This innovation seamlessly transitions to reveal an aft sun pad and seating area. The wet galley, complete with a fridge, sink, and grill, complements outdoor dining. Forward, the helm station and a supplementary rest area are sheltered under an automatic sunroof.

FLAWLESS PERFORMANCE

Catering to active enthusiasts, the spacious bow sundeck is suited for relaxation and cruising alike. A hydraulic platform facilitates water access and toy retrieval from the aft garage.

Below, an expansive saloon and kitchen maximize space for various activities. Abundant hull windows and glass panels infuse the interior with natural light. The owner's cabin features a spacious double bed, en suite bathroom, and a cozy rest area. The guest VIP quarters grace the bow, boasting a private bathroom entrance and functional wardrobe.

The 405 HTS excels as a sport cruiser, harmonizing handling and performance. It accommodates onboard activities while ensuring the comfort of four guests.

SPORT CRUISER LINE

Step aboard the 405 to embrace an exhilarating journey of performance, agile handling, and a thrilling ride, as you enter one of the most sport-oriented yachts within the Galeon lineup.



405 HTS

Aggressive styling promises sporty performance



Slide open the spacious sunroof to invite in the refreshing breeze —



The cockpit area can be protected by a retractable soft top —



WALNUT

Main living area down below complete with a kitchen and dining area

405 HTS



A well appointed kitchen for meal preparation



Bow VIP cabin with skylights above



Midship cabin holds a double bed



Both guest cabins offer private bathrooms



— Easy access to the lower deck



— Rest area opposite the helm station



— The wet galley is located in the cockpit



— All fresco dining area

405 HTS

FLAWLESS PERFORMANCE

LAYOUTS

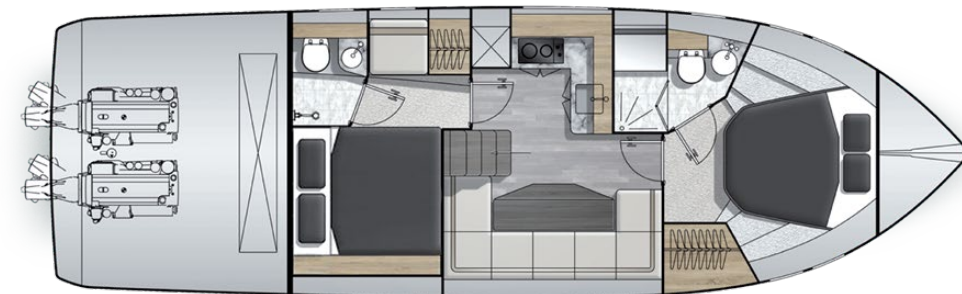
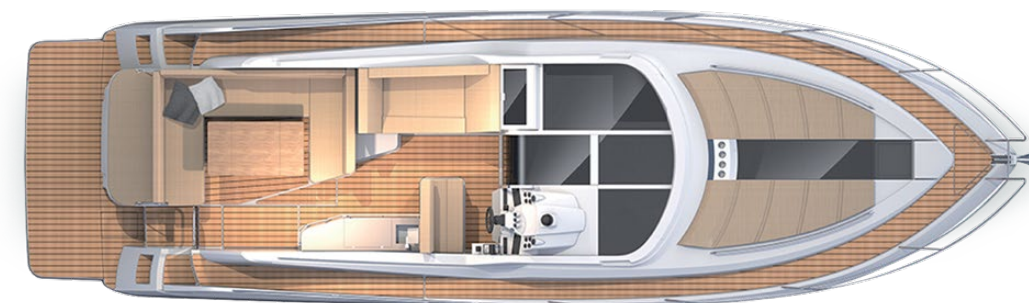

TECHNICAL SPECIFICATION

Length of the hull	[m]	11,99
Length overall	[m]	13,46
Beam of the hull	[m]	3,84
Beam overall	[m]	3,90
Draft max ₁	[m]	1,20
Bridge clearance ₂	[m]	4,98
Height to transport	[m]	4,56
Fuel tank capacity	[dm ³]	950
Water tank capacity	[dm ³]	450
Grey water tank	[dm ³]	250
Black water tank	[dm ³]	160
Mass of Light Craft Condition ₃	[kg]	10300
Maximum Load	[kg]	2580
Min. engine (-s) power	[kW/hp]	2x169/230
Max. engine (-s) power	[kW/hp]	2x324/440
Crew limit		10
Category		B

₁ - without propellers ₂ - Max. height from water line at draft min. ₃ - minimum mass with base engines

TECHNOLOGY

