

# 425 HTS

The 425 instantly emanates a sporty essence, purposefully designed for dynamic driving and adventure enthusiasts. Engineered with a low center of mass, it caters to active drivers and thrill-seekers. The striking profile, accentuated by optional dual colorways, black radar domes, and side air intakes, guarantees attention in any marina.

The main deck embraces utility, highlighted by a smart mechanism allowing the raising of the dividing window to expand the entire space. The cockpit boasts a convertible seat and sun pad combination, crowned with a table atop extra storage and a garage. This compartment can accommodate an inflatable dinghy and various water toys, easily accessible from the bathing platform during anchor stops.

## THE EXPRESS CRUISER

The helm is enclosed, accompanied by a settee for six and a wet bar with a fridge for serving refreshments. The driver's area features accessible starboard windows and a sunroof for enjoying the breeze. Closing off the cockpit provides access to heating and air conditioning, enhancing comfort.

Below deck, a cozy saloon with a well-equipped kitchenette awaits passengers. The 425 features two double cabins—the master midship spanning the yacht's width and the VIP cabin forward. Both offer standing height, illuminated by large hull windows and skylights. The bathroom provides a separate shower cabin and ample storage.

The 425 HTS is a comprehensive cruiser excelling in handling, smart interior layout, and a genuinely stylish and sporty exterior design.

## SPORT CRUISER LINE

The 425 embraces express cruiser norms, featuring open main deck spaces with a creative touch. A glass door and window combo separate and shelter the cockpit, providing heating and air conditioning options, ideal for varying climates.





# 425 HTS

The sport cruiser lineup was designed with performance in mind



Two-tone colorway adds flair to an already striking design



Sunpad morphs into cockpit seating



**WALNUT HIGH GLOSS**  
A generous owner's cabin spreads over the whole beam

**425 HTS**



Luxury finish down below



A well appointed galley area



Bow VIP cabin with skylights



Spacious bathroom with separate shower cabin



— Bow sundecks with back support



— All fresco dining at its finest



— Bath platform for easy water access



— Sporty touches abound from every angle

# 425 HTS

## THE EXPRESS CRUISER

### LAYOUTS

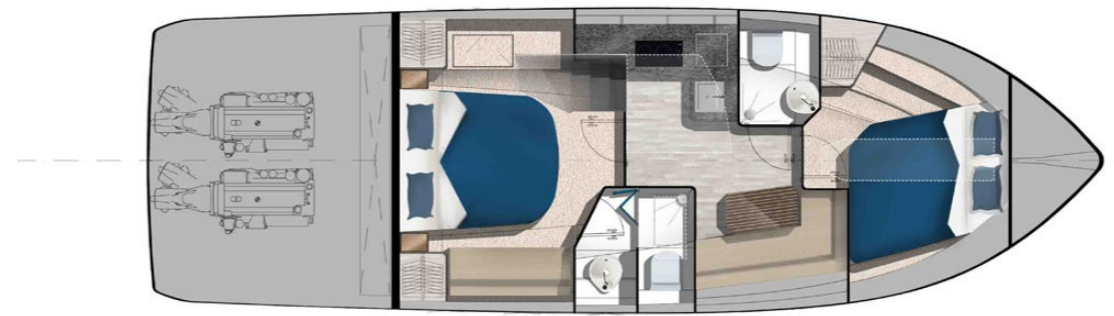
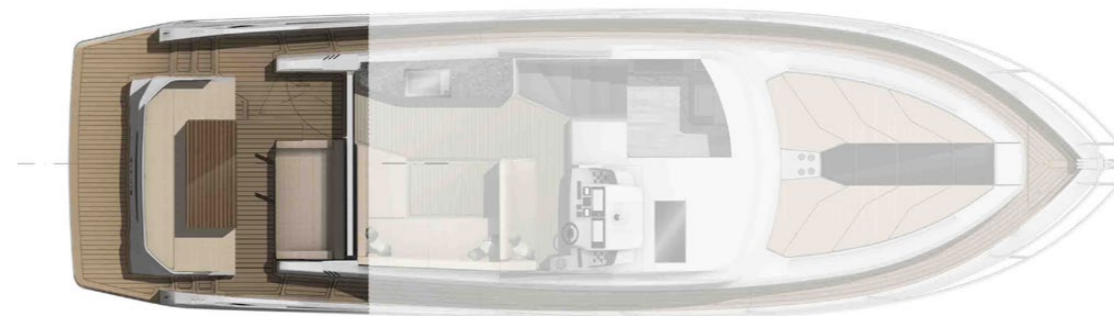

### TECHNICAL SPECIFICATION

Length of the hull	[m]	11,99
Length overall	[m]	13,46
Beam of the hull	[m]	3,84
Beam overall	[m]	3,90
Draft max <sub>1</sub>	[m]	1,09
Bridge clearance <sub>2</sub>	[m]	4,40
Height to transport	[m]	4,30
Fuel tank capacity	[dm <sup>3</sup> ]	950 or 2 x 475
Water tank capacity	[dm <sup>3</sup> ]	450 <sub>5</sub> or 360 <sub>6</sub>
Grey water tank	[dm <sup>3</sup> ]	250
Black water tank	[dm <sup>3</sup> ]	160
Mass of Light Craft Condition <sub>3</sub>	[kg]	12425
Maximum Load	[kg]	2770
Min. engine (-s) power	[kW/hp]	2x169/230
Max. engine (-s) power	[kW/hp]	2x328/440
Crew limit		10
Category		B

<sub>1</sub> - without propellers    <sub>2</sub> - Max. height from water line at draft min.    <sub>3</sub> - minimum mass with base engines  
<sub>5</sub> - EU mode    <sub>6</sub> - USA Mode

### TECHNOLOGY

