

# 440 *FLY*

The fusion of a dynamic silhouette and sporty accents is enhanced by expansive windows on both decks, brightening the interior. Emphasizing practicality and accessibility, the design seamlessly integrates all outdoor spaces to accommodate passengers.

The top deck features a helm station complemented by a port-side settee for a companion. The primary rest area is strategically positioned further back, enveloped by an L-shaped sofa surrounding an elongated table, comfortably seating six. A well-equipped wet bar complements the arrangement. On the main deck find two distinct leisure zones with the bow easily reachable via starboard sliding doors adjacent to the helm. The foldable bimini and front-facing seat offer additional protection from the elements.

The cockpit is enhanced by a full-sized hydraulic stern platform and the innovative Beach Mode, featuring semi-glazed panels that

## *AN EXCITING ENDEAVOR*

drop down on both sides. This expansion of space during mooring invites guests to partake in activities such as diving, fishing, or sunbathing. The versatile bath platform doubles as a lift for water toys and conveniently grants access to the stern-facing grill area.

Internally, a classic layout unfolds, with the rest area thoughtfully positioned toward the rear, separated from the cockpit solely by sliding glass doors. The galley and helm station occupy a forward stance, while the cabins are situated on the lower deck.

Accommodating four passengers in comfort, the lower deck showcases a mid-ship master and a forward VIP, both with ample storage. For larger groups, a three-cabin layout featuring bunk beds is available. Both lower-level bathrooms are equipped with a head and shower, boasting standing height for added convenience.

## *FLYBRIDGE LINE*

Drawing upon its rich boat-building expertise, Galeon introduces a medium-sized flybridge that stands as a testament to innovation and a fresh perspective on onboard space allocation.





# 440 FLY

Packed with amazing innovations and a new approach to on board space distribution



Beach Mode extends the usable cockpit area



Oversized flybridge comes complete with a wet bar



LATI GREY  
Entertainment and dining area is moved back

440 FLY



Double seat at the helm station



Port side window can be lowered to air the galley area



Forward VIP cabin with slidable beds



Master bedroom offers a double bed and great storage



— Top deck helm station



— Extend the tables for al fresco dining



— Bow area can be fitted with a bimini



— Ample cockpit area with glazed balconies

# 440 FLY

AN EXCITING ENDEAVOR

## LAYOUTS

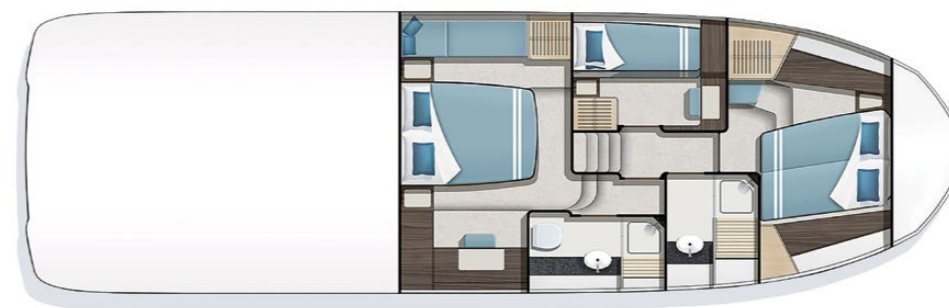
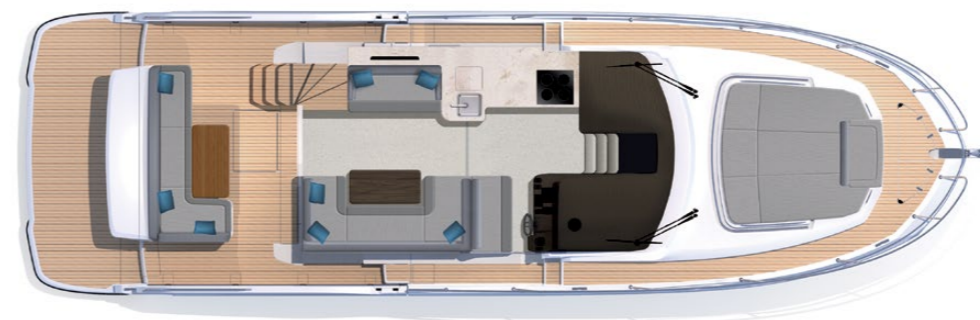
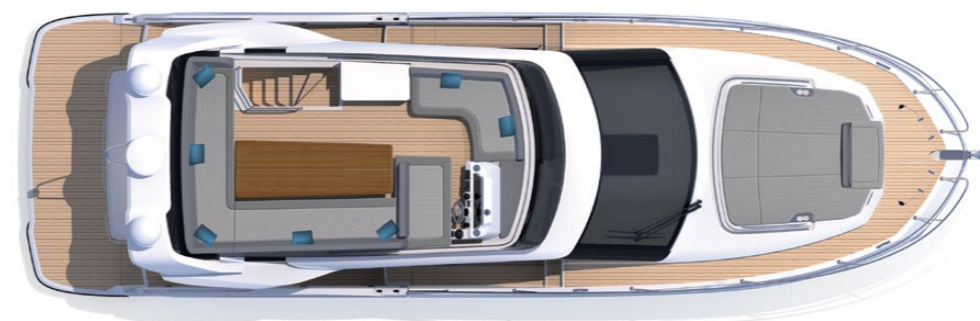

## TECHNICAL SPECIFICATION

Length of the hull	[m]	12,94
Length overall	[m]	13,97
Beam of the hull	[m]	4,21
Beam overall	[m]	4,31/6,35 <sub>4</sub>
Draft max <sub>1</sub>	[m]	0,81 (1,30) <sub>7</sub>
Bridge clearance <sub>2</sub>	[m]	5,05 (4,55)
Height to transport	[m]	4,25
Fuel tank capacity	[dm <sup>3</sup> ]	2 x 800
Water tank capacity	[dm <sup>3</sup> ]	450
Grey water tank	[dm <sup>3</sup> ]	220
Black water tank	[dm <sup>3</sup> ]	120
Mass of Light Craft Condition <sub>3</sub>	[kg]	17672
Maximum Load	[kg]	3870
Min. engine (-s) power	[kW/hp]	2x324/440
Max. engine (-s) power	[kW/hp]	2x441/600
Crew limit		14
Category		B

<sub>1</sub> - without propellers    <sub>2</sub> - Max. height from water line at draft min.    <sub>3</sub> - minimum mass with base engines  
<sub>4</sub> - with Beach mode, balconies down    <sub>7</sub> - bare hull (hull with appendage)

## TECHNOLOGY

